

Paw Print Trail Exhibit Guide

- | | |
|---|--|
| 1 Welcome and Directions | 39 Equine Parade of Breeds: SCAAEP** |
| 2 It Takes a Village | 40 Equine Treadmill: AAEP** |
| 3 Veterinary Medicine History | 41 Farrier (Horseshoeing) |
| 4 Great Rover Road Run | 42 Petting Zoo |
| 5 LSU SVM Student and Academic Affairs | 43 Equine Intensive Care Unit (viewing area) |
| 6 Animal Magazine Online | 44 Critical Care/ Foal Team |
| 7 BREC's Baton Rouge Zoo | 45 Equine Ultrasound: SCAAEP |
| 8 Magic Happens Rabbit Rescue | 46 Raptor and Wildlife Rehabilitation |
| 9 Great Dane Club of LA | 47 Nuclear Scintigraphy |
| 10 EBR Animal Control Center | 48 Underwater Treadmill -Companion Animal Rehabilitation (CARE-Center)** |
| 11 Gulf South Golden Retriever Rescue | 49 Radiology (X-rays, CAT scans) |
| 12 Whippet Rescue & Placement (WRAP) | 50 Respiratory Physiology |
| 13 Greyhound Pets of America | 51 Teddy Bear Repair |
| 14 Italian Greyhound Rescue | 52 Clinical Pathology |
| 15 Shelter Medicine | 53 Cardiology |
| 16 Southern States Rescued Rottweilers | 54 Pathology |
| 17 Ophthalmology | 55 Parasitology |
| 18 Fluker Farms | 56 "Scrub Up Like a Surgeon" |
| 19 Christian Veterinary Mission | 57 LADDL: White Spot Disease of Crawfish |
| 20 SCVECCS Animal Endoscopy | 58 SCASLAP Lab Animal Medicine |
| 21 Tiger HATS Pet Therapy | 59 Equine Fibrous Support Mechanism |
| 22 SCVECCS Animal CPR | 60 Anatomy Lab |
| 23 Cancer Treatment Unit** | 61 SCAAFP Feline Medicine |
| 24 Companion Animal ICU (viewing area) | 62 Toxicology |
| 25 Hill's Pet Nutrition | 63 CAAWS- Capital Area Animal Welfare Society |
| 26 Small Animal Surgery (viewing area) | 64 Children's Wall Mural |
| 27 IVD Royal Canin | 65 Audubon Center for Research of Endangered Species (ACRES) |
| 28 U.S. Army Veterinary Corps | 66 Snack Bar: Food and Drinks |
| 29 International Vets | 67 AniMall: Merchandise for sale to benefit student organizations |
| 30 Nestle Purina Pet Care Company | 68 "I wanna be a Horse Doctor when I grow up" (SCAAEP) |
| 31 Novartis Animal Health | 69 Reptile, Amphibian, and Avian Medicine |
| 32 Equine Health Studies Program | 70 Auditorium: Scheduled Speakers |
| 33 Fort Dodge Animal Health | |
| 34 Equine Arthroscopy: SCAAEP | |
| 35 Hildy, the Fistulated Cow: SCAABP | |
| 36 Lafayette Sheriff's Dept. K-9 Corp LSU Bomb Dogs** | |
| 37 Deep South Region U.S. Pony Club | |
| 38 Heifer International | |

~IMPORTANT NOTICE~
The Centers for Disease Control and the American Veterinary Medical Association recommend that all visitors, especially children, wash their hands after handling animals and before eating. Restrooms, hand-wash stations, and hand sanitizer are available throughout the building.

LSU SCHOOL OF VETERINARY MEDICINE 2008 PAW PRINT TRAIL



Please remember during your visit that this is a functioning teaching hospital. We ask your cooperation by staying on the marked trail for your safety and the safety of our patients.

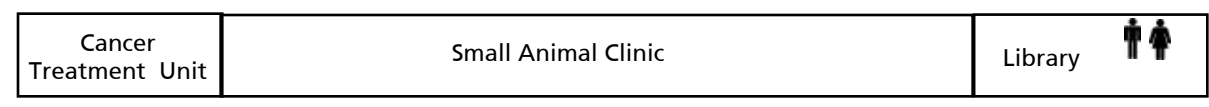
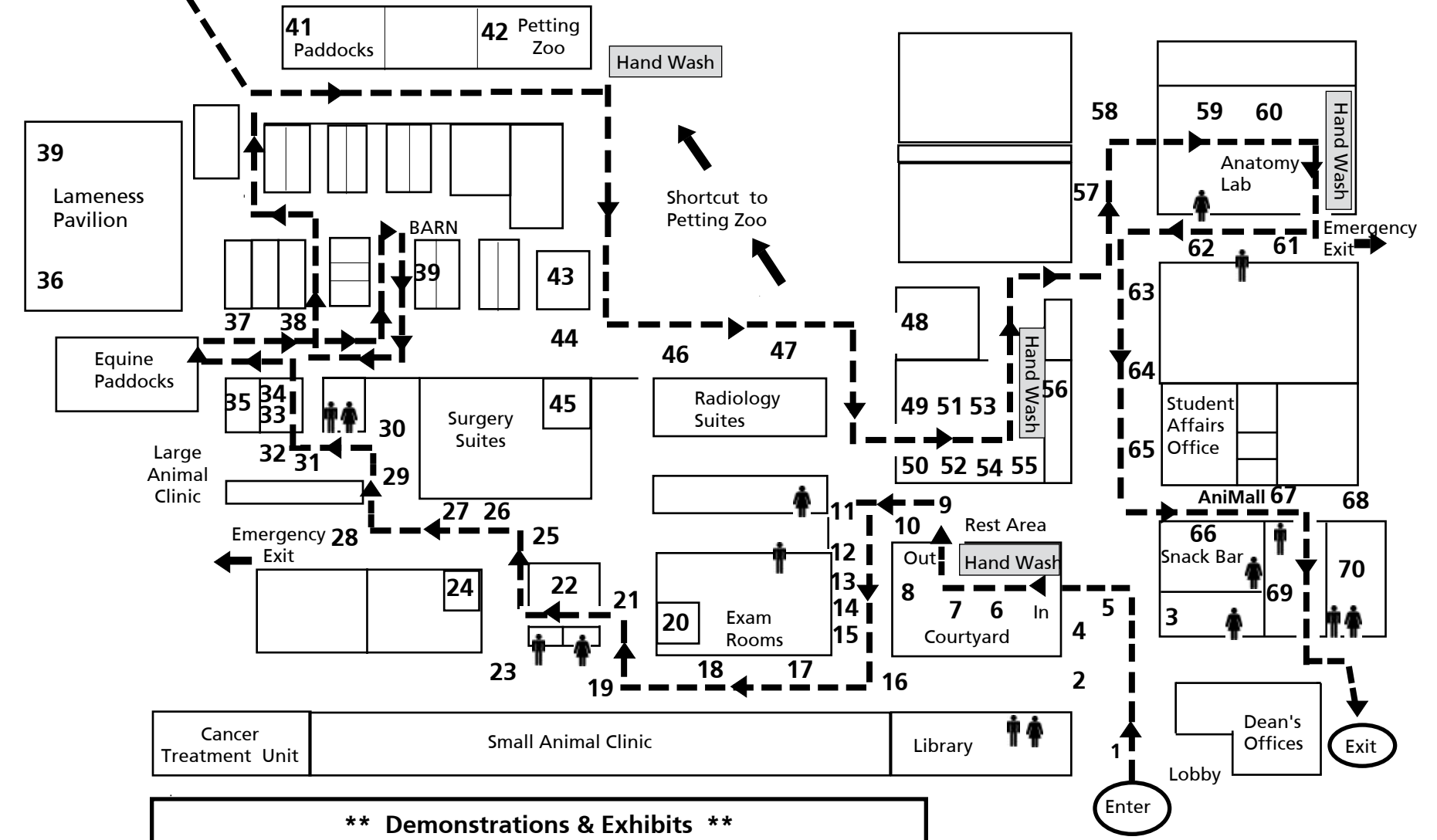

**** Demonstrations & Exhibits ****

#23 Cancer Treatment Unit	9:30, 11:00
#36 Lafayette Sheriff's Dept. K-9 Corp/ LSU Police K-9 Bomb Unit Demo	9:30, 10:00, 11:00, and 11:30
#40 Equine Treadmill	9:30, 10:00, 10:30, 11:00, 11:30, 12:00, 12:30, 1:00, 1:30, 2:00, 2:30, 3:00
#48 Underwater Treadmill	9:45, 10:15, 10:45, 11:15, 11:45, 12:15, 12:45, 1:15, 1:45, 2:15
#39 Equine Parade of Breeds	10:30 and 2:00
Front Lawn	
Canine "Meet the Breed"	10:00 and 2:30
Baton Rouge Police K-9 Corps Demo	10:30 and 12:00
Canine Parade of Breeds	12:15

Restrooms No Smoking inside the SVM building or courtyard

Presentations in Auditorium (#70 on the Trail)

Pets and Children by Dr. Martha Littlefield	11:00
Common Household Toxins by Dr. Susan Eddlestone	1:00
What Should I Do When My Animal Has a Broken Bone? by Dr. Susanne Lauer	1:45
So You Want to Be a Veterinarian? by Dr. Joseph Taboada	3:00

OPEN HOUSE COMMITTEE

The Open House Committee would like to welcome you to the 26th Annual Open House at the Louisiana State University School of Veterinary Medicine. We hope your experience is educational, as well as enjoyable.

Cyndi Albert, Class of 2009, Committee Co-Chair
Emelie McLellan, Class of 2009, Committee Co-Chair
Erin Daniels, Class of 2010
Lauren Orvin, Class of 2010
Tristan Colonius, Class of 2011
Morgan Daigle, Class of 2011

Dr. Charles McCauley, Veterinary Clinical Sciences
Dr. Daniel Hillmann, Comparative Biomedical Sciences
Dr. Jeffrey Sirninger, Pathobiological Sciences
Rob Poston, Louisiana Animal Disease Diagnostic Lab
Pat Edwards, Institutional Advancement
Gretchen Morgan, Alumni & Public Programs
Ginger Guttner, Public Relations

SCHOOL OF VETERINARY MEDICINE ADMINISTRATION

Dr. Peter F. Haynes, Dean
Dr. Thomas R. Klei, Research and Advanced Studies
Dr. Joseph Taboada, Student and Academic Affairs
Dr. David Senior, Advancement and Strategic Initiatives
Ernie Tanoos, Finance and Administrative Services

SPONSORS

Our grateful thanks to the following Open House sponsors:



Participation in Open House by non-SVM groups does not constitute endorsement of products or services by the School of Veterinary Medicine.

SCHOOL OF VETERINARY MEDICINE LOUISIANA STATE UNIVERSITY

The LSU School of Veterinary Medicine admitted its first students to the professional curriculum during the 1973-74 academic year. The original entering class consisted of 36 students, all residents of Louisiana. Class size has increased significantly in recent years. With the graduating class of 2007, 2,173 students have successfully completed the four-year curriculum and received a Doctor of Veterinary Medicine degree at the LSU School of Veterinary Medicine.

The School has an excellent faculty supported by modern equipment. The Veterinary Medicine Building, located on the west side of the campus near the Mississippi River, was dedicated in October 1978. It houses three academic departments, as well as the Veterinary Medical Library, the Veterinary Teaching Hospital and Clinics, and the Louisiana Animal Disease Diagnostic Laboratory. The facilities at the Veterinary Teaching Hospital and Clinics are used as classrooms where students are introduced to clinical cases and animal disease problems, as well as to methods and techniques used in their solution. The clinical case load at the hospital, in-field services, and herd health programs offer ample opportunities for the education of the complete veterinarian. Advanced degrees -- the Master of Science and Doctor of Philosophy -- in veterinary medical sciences are offered through the Graduate School.

The LSU program is accredited by the Council on Education of the American Veterinary Medical Association, the national accrediting agency for veterinary medical education in the United States. Full accreditation was granted in 1977 and reaffirmed in 1984, 1991, 1998, and 2006. In addition, a certificate of commendation for excellence from the Louisiana Board of Regents was awarded in 1980.

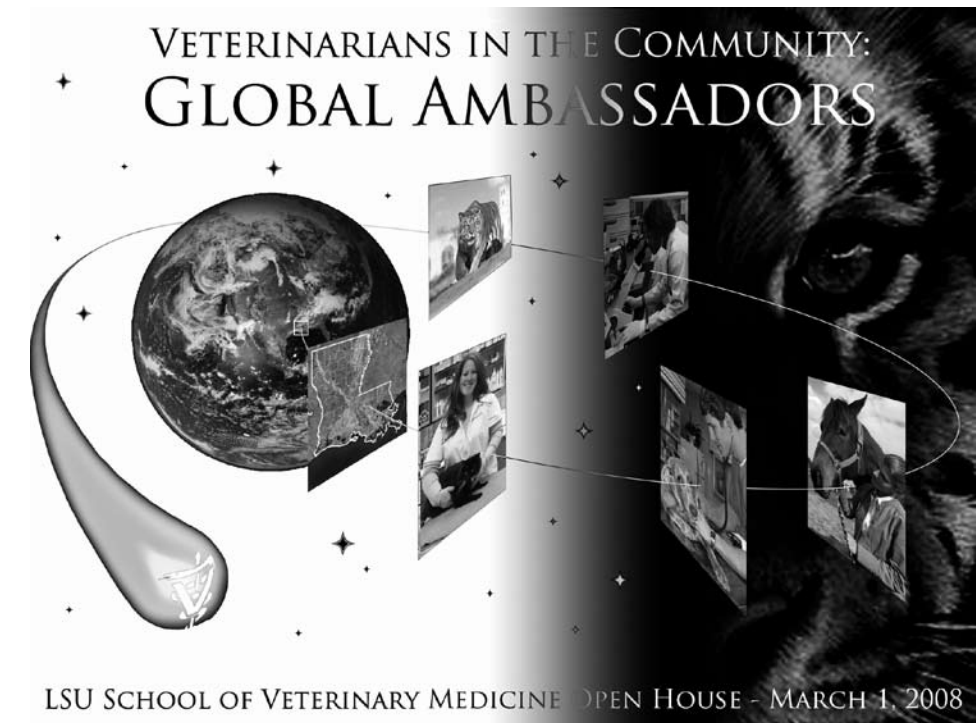

26TH ANNUAL LSU SCHOOL OF VETERINARY MEDICINE OPEN HOUSE MARCH 1, 2008

