

OPEN HOUSE COMMITTEE

The Open House Committee would like to welcome you to the 28th Annual Open House at the Louisiana State University School of Veterinary Medicine. We hope your experience is educational, as well as enjoyable.

Tristan Colonius, Class of 2011, Committee Co-Chair
Morgan Daigle, Class of 2011, Committee Co-Chair
Shannon Gaharan, Class of 2012
Claire Hutchinson, Class of 2012
Stephanie Rutherford, Class of 2012
Erika Fauth, Class of 2013
Eli Landry, Class of 2013
Emily Strecker, Class of 2013

Gretchen Morgan, Director of Annual Giving and Alumni Affairs
Ginger Guttner, Public Relations Coordinator

SCHOOL OF VETERINARY MEDICINE ADMINISTRATION

Dr. Peter F. Haynes, Dean
Dr. Thomas R. Klei, Associate Dean for Research and Advanced Studies
Dr. Joseph Taboada, Associate Dean for Student and Academic Affairs
Dr. David Senior, Associate Dean for Advancement and Strategic Initiatives
Ernie Tanoos, Assistant Dean for Finance and Administrative Services

SPONSORS

Our grateful thanks to the following Open House sponsors:



Bayer HealthCare



Participation in Open House by non-SVM groups does not constitute endorsement of products or services by the LSU School of Veterinary Medicine.

SCHOOL OF VETERINARY MEDICINE LOUISIANA STATE UNIVERSITY



The LSU School of Veterinary Medicine admitted its first students to the professional curriculum during the 1973-74 academic year. The original entering class consisted of 36 students, all residents of Louisiana. Class size has increased significantly in recent years. With the graduating class of 2009, 2,338 students have successfully completed the four-year curriculum and received a Doctor of Veterinary Medicine degree at the LSU School of Veterinary Medicine. Advanced degrees—the Master of Science and Doctor of Philosophy—in veterinary medical sciences, pathobiological sciences, and comparative biomedical sciences are also offered at LSU SVM.

The School has an excellent faculty supported by modern equipment. The Veterinary Medicine Building, located on the west side of the campus near the Mississippi River, was dedicated in October 1978. It houses three academic departments, as well as the Veterinary Medical Library, the Veterinary Teaching Hospital and Clinics, and the Louisiana Animal Disease Diagnostic Laboratory. The facilities at the Veterinary Teaching Hospital and Clinics are used as classrooms where students are introduced to clinical cases and animal disease problems, as well as to methods and techniques used in their solution. The clinical case load at the hospital, in-field services, and herd health programs offer ample opportunities for the education of the complete veterinarian.

**For more information about the
LSU School of Veterinary Medicine,
go to www.vetmed.lsu.edu.**

**To subscribe to LSU SVM's monthly e-newsletter, go to
www.vetmed.lsu.edu/newsletter_subscribe.htm.**

**Administration 225-578-9900
Admissions 225-578-9537
Small Animal Clinic 225-578-9600
Large Animal Clinic 225-578-9500**

 LSU School of Veterinary Medicine
 LSUvetMed



28TH ANNUAL OPEN HOUSE

February 6, 2010



Paw Print Trail Exhibit Guide

- | | |
|---|--|
| 1 Welcome and Directions | 30 Louisiana State Animal Response Team/Fire & Emergency Training Institute* |
| 2 Great Rover Road Run | 31 Equine Parade of Breeds* |
| 3 Veterinary Medicine History | 32 River Riders Pony Club (U.S. Pony Club) |
| 4 LSU SVM Student and Academic Affairs | 33 Equine Treadmill* |
| 5 The Pit Krewe | 34 Equine Emergency Rescue |
| 6 Magic Happens Rabbit Rescue | 35 Petting Zoo: A Trip to the Farm |
| 7 BREC's Baton Rouge Zoo | 36 Equine Intensive Care Unit |
| 8 Great Dane Club of LA | 37 Equine Ultrasound |
| 9 Christian Veterinary Mission | 38 Raptor and Wildlife Rehab |
| 10 Best Friends Animal Society | 39 Nuclear Scintigraphy |
| 11 U.S. Army Veterinary Corps | 40 Underwater Treadmill-CARe Center* |
| 12 Southern States Rescued Rottweilers | 41 Diagnostic Imaging |
| 13 Cardiology | 42 Respiratory Physiology |
| 14 Ophthalmology | 43 Pathology |
| 15 National War Dog Memorial | 44 Clinical Pathology |
| 16 Animal Endoscopy: Student Chapter of the Veterinary Emergency and Critical Care Society* | 45 Teddy Bear Repair |
| 17 Tiger HATS Pet Therapy | 46 Parasitology |
| 18 Cancer Treatment Unit* | 47 Scrub Up Like a Surgeon |
| 19 Companion Animal ICU | 48 Audubon Center for Research of Endangered Species (ACRES) |
| 20 American Association of Feline Practitioners | 49 Lab Animal Club |
| 21 Surgical Suite | 50 Anatomy Lab |
| 22 International Vets | 51 Equine Fibrous Support |
| 23 Gulf South Golden Retriever Rescue | 52 Whippet Rescue and Placement |
| 24 Canine Connection - EBR 4-H Dog Club | 53 Greyhound Pets of America |
| 25 Equine Health Studies Program | 54 Italian Greyhound Rescue |
| 26 Equine Arthroscopy: Student Chapter of the American Association of Equine Practitioners | 55 Children's Wall Mural |
| 27 Magnetic Resonance Imaging (MRI) | 56 Capital Area Animal Welfare Society (CAAWS) |
| 28 The Dog Run | 57 AniMall |
| 29 Hildy, The Fistulated Cow: Student Chapter of the American Association of Bovine Practitioners | 58 Snack Bar |
| | 59 Reptile, Amphibian, and Avian Medicine |

***Special tours/demonstrations**

IMPORTANT NOTICE
 The Centers for Disease Control and the American Veterinary Medical Association recommend that all visitors, especially children, wash their hands after handling animals and before eating. Restrooms, hand-wash stations, and hand sanitizer are available throughout the building.

LSU SCHOOL OF VETERINARY MEDICINE 2010 PAW PRINT TRAIL
 Please remember during your visit that this is a functioning teaching hospital. We ask your cooperation by staying on the marked trail for your safety and the safety of our patients.

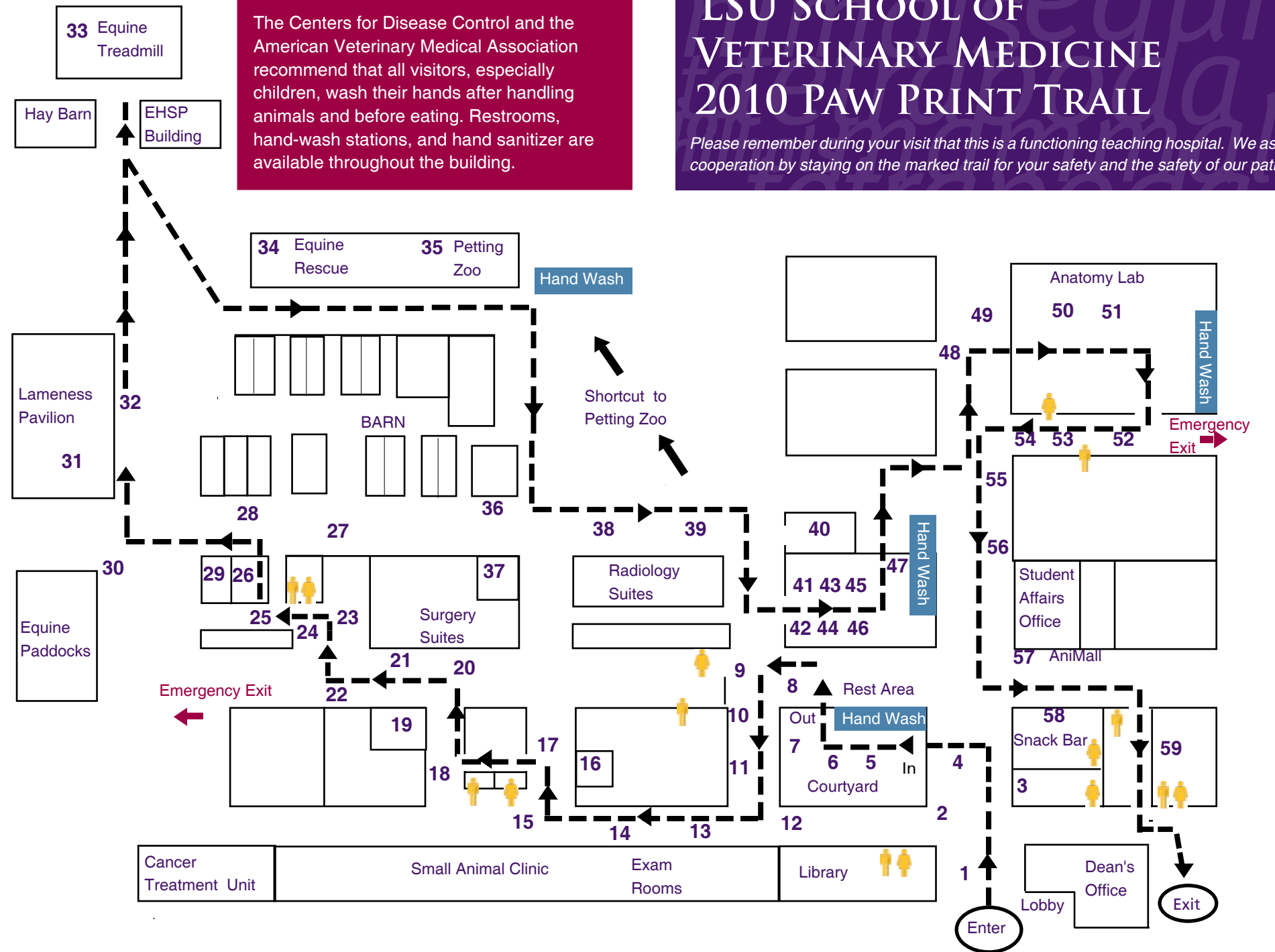

Hospital and Barn Demonstrations and Exhibits

#16 Animal Endoscopy: SCVECCS	9:30-10:30, 11-12, 12:30-1:30, 2-3
#18 Cancer Treatment Unit	9, 10, 11, 12
#29 LSART/FETI	11:30 and 2:45
#30 Equine Parade of Breeds	11 and 2
#32 Equine Treadmill	9:30, 10, 10:30, 11, 11:30, 12 12:30, 10, 1:30, 2, 2:30
#39 Underwater Treadmill	9:45, 10:15, 10:45, 11:15, 11:45, 12:15 12:45, 1:15, 1:45, 2:15

Front Lawn Demonstrations and Exhibits

Baton Rouge Police K-9 Corps Demo	10 and 1
Mike VI, LSU's Tiger Mascot	11-12:30
LA Capital City Obedience Club	11 and 2
Canine Parade of Breeds	12
Shelter Medicine	
LSU SVM Mobile Unit	
EBR Animal Control	



No Smoking inside the SVM building or courtyard